

# HERA-B and the Lumi Shut-Down

## Contents:

- 1) Introduction
- 2) Time schedule of HERA
- 3) Consequences for HERA-B
- 4) HERA-B time schedule, [see HERA-B Web-page "Time schedules"](#)

No tram access to HERA tunnel via South or North. Use halls West and East to have access to adjacent quadrants.

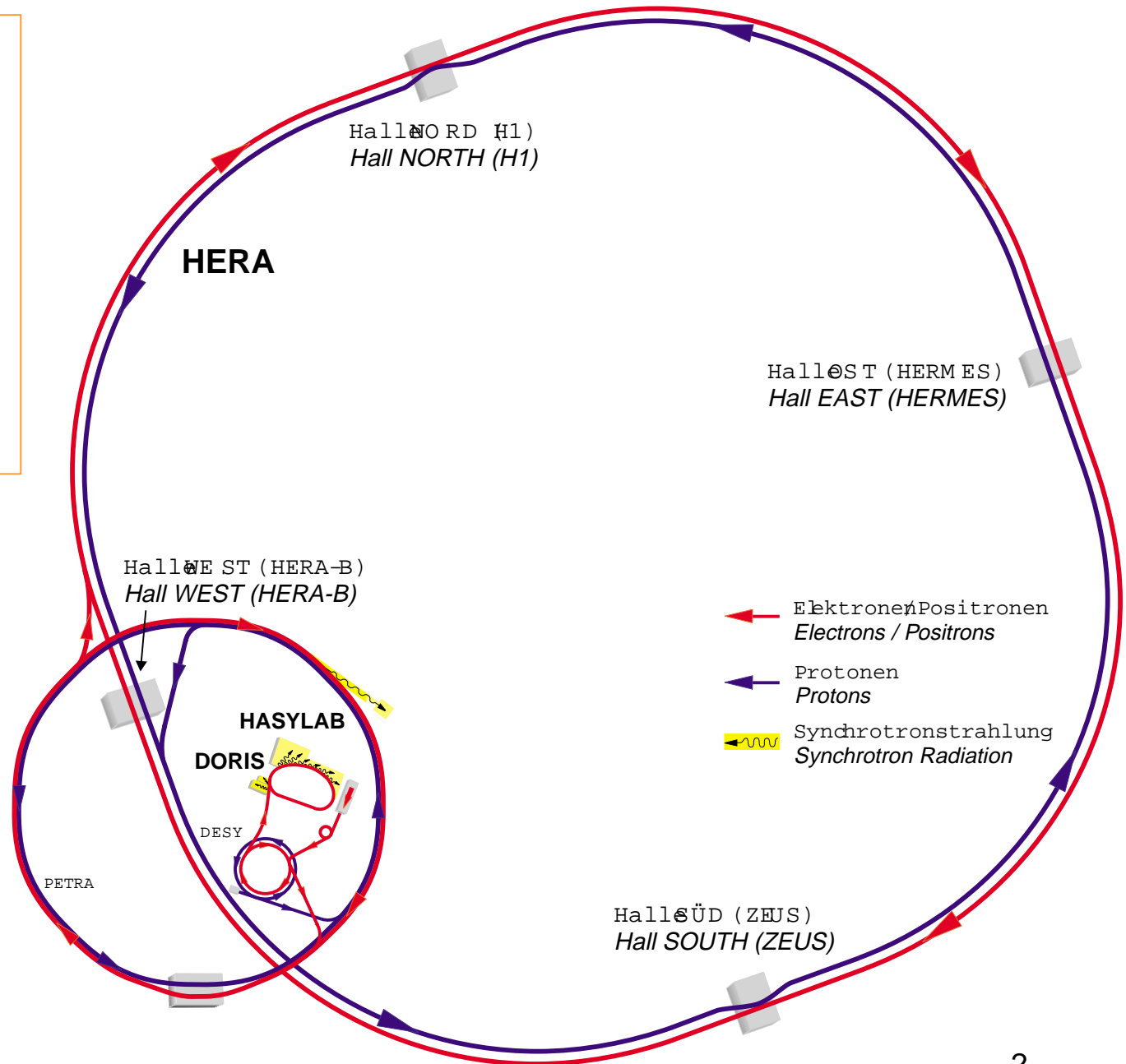

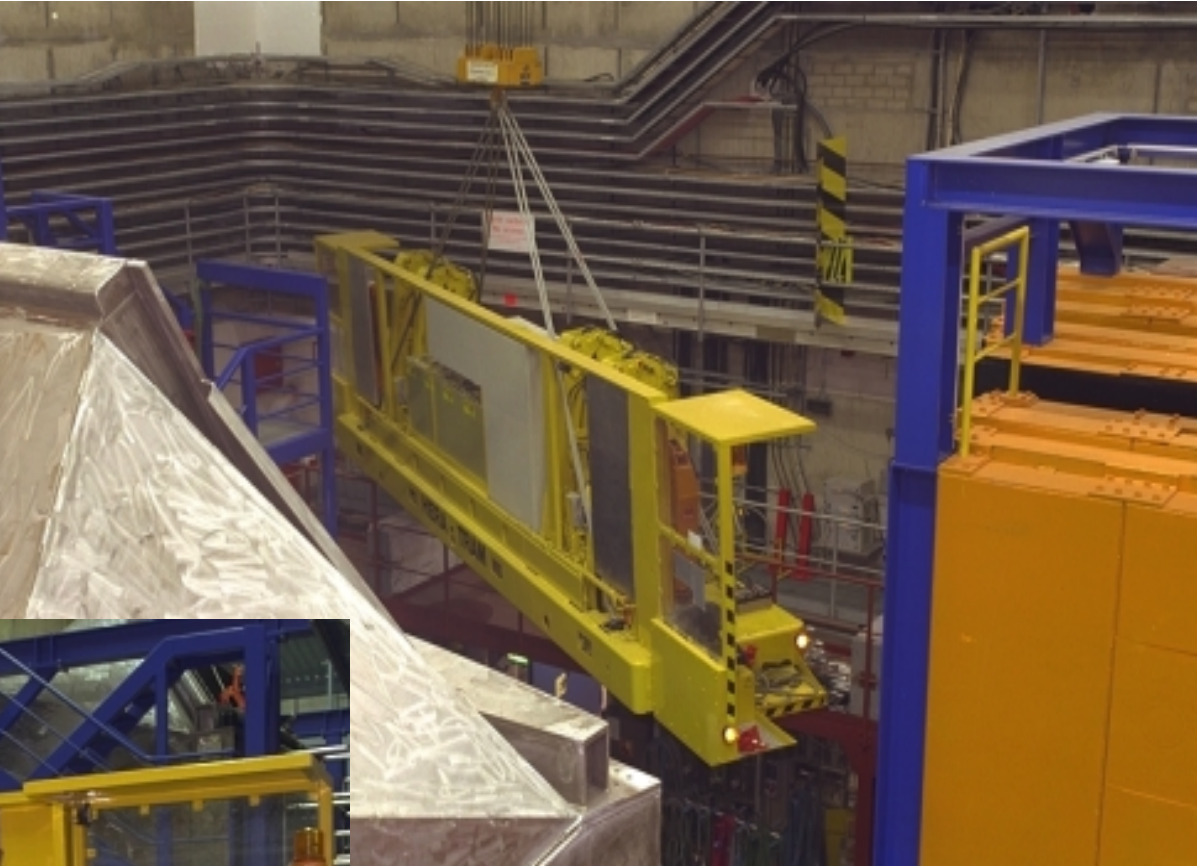

## **Time schedule of HERA:**

- 04.09.00 Begin of shut-down
- 18.09.00 Begin of tram operation in hall West
- 10.11.00 Service week for HERA-B (beam position)
- 29.03.01 End of tram operation in hall West
- 05.06.01 Shielding closed, interlock test
- 15.06.01 Restart of HERA

# HERA-B in beam position

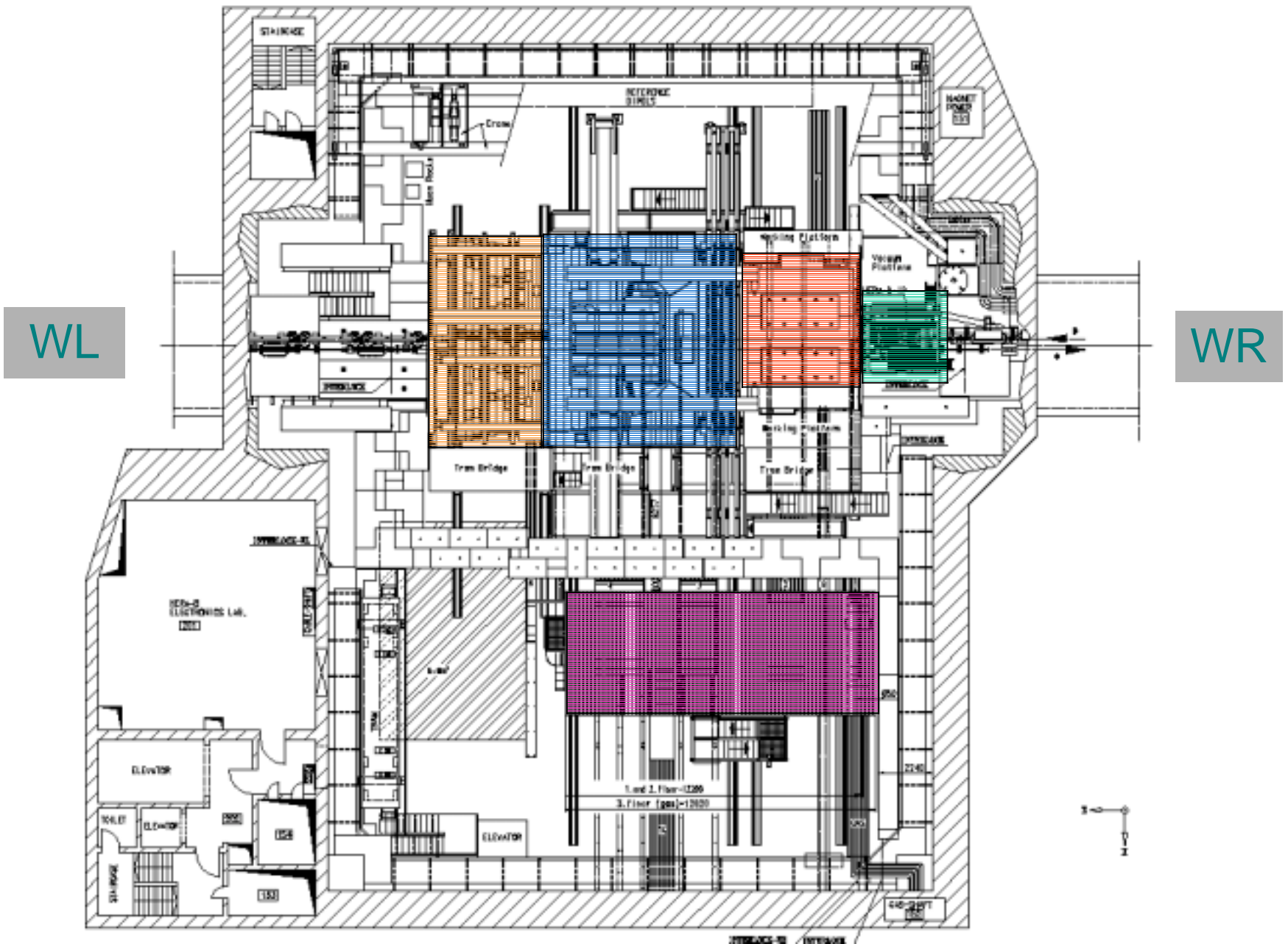

## Time schedule of HERA-B:

A) The first two weeks 04. - 18.09

- Remove shielding, store outside hall West
- Remove electron and proton beam-pipes
- Open PC1-, PC4-, remove bad modules  $\Rightarrow$  hall 5
- Remove TC1 $\pm$ , TC2+ chambers and store in hall
- Remove ITR chambers (MS10-, MS13-) + ????
- Remove VDS vessel ???
- Move HERA-B in tram position



## Time schedule of HERA-B:

### B) Access to HERA-B Components:

See <http://www-hera-b.desy.de.subgroup/infra/Schedule.html>

### C) Service week 10. - 17.11.00

- Move detector in beam position
- Install required extension beams
- Remove/install/repair/destroy .....
- Access to PC, TC chambers more difficult, scaffoldings required
- Remove extension beams, shift detector in tram position



